

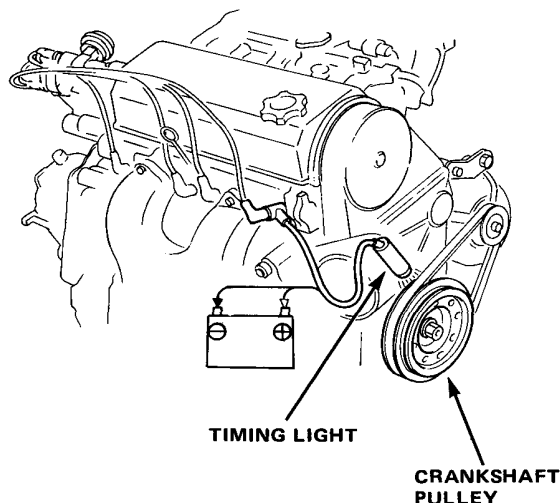

## Ignition Timing

1. Connect the timing light to the engine.



2. Start the engine and allow it to warm up (cooling fan comes on), then point the timing light toward the pointer on the timing belt cover.

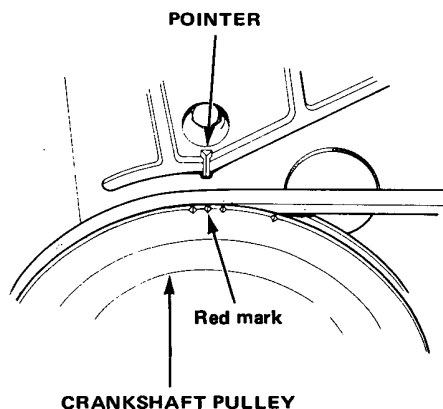

3. Adjust ignition timing, if necessary, to the following specifications:

**All models:** Red mark at idle  
(manual in neutral; automatic in gear)

**Idle Speed:** Manual  $750 \pm 50 \text{ min}^{-1} \text{ (rpm)}$   
Automatic  $700 \pm 50 \text{ min}^{-1} \text{ (rpm)}$

4. Loosen distributor adjusting bolt, and turn distributor housing counterclockwise to advance timing or clockwise to retard timing.

**Carburetor model:**

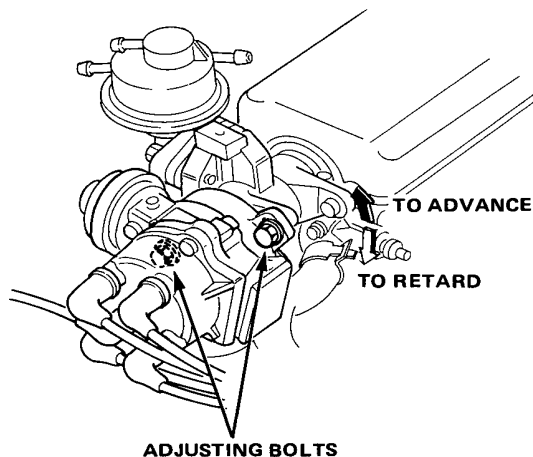

**PGM-FI model:**

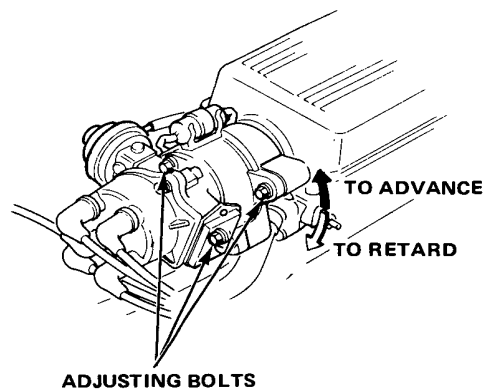

5. Tighten the adjusting bolt.
6. Recheck the timing.